



 **MIL-WASH**

PSLU 206008 8
22G1
M.G.W.
TARE 37,500 655
4,450 183
NET
CU. CAP. 88,500 655
334 176 607.1

3381
62711 509008 8



STOP the needless dependency on expensive and unreliable foreign vehicle cleaning contractors
END the pointless drama of preparing for U.S. Custom inspections
INCREASE readiness by **DECREASING** vehicle cleaning time by 50 percent
STOP worrying about the weather and wash in any environmental condition

THE PROBLEM:



CURRENT WASH SYSTEMS ARE:

- ◀ Not ruggedized for military operations
- ◀ Not designed for Soldiers, Marines and Airmen to setup, operate and maintain
- ◀ Not engineered to operate in hostile arctic and desert conditions
- ◀ Not built to process and bag tons of mud and debris without stoppage
- ◀ Not designed for cleaning multiple armored vehicles simultaneously
- ◀ Not designed to operate 24 /7 without stopping
- ◀ Not designed for a dual-use chemical decontamination system

THE SOLUTION:

MIL-WASH:

- ▶ Designed for operators to setup, operate & maintain
- ▶ Built & designed expressly for military operations in remote areas
- ▶ Engineered to operate in all weather environments (minus 41 degrees)
- ▶ Built to automatically process and bag thousands of pounds of sludge without stoppage
- ▶ Designed to clean two to four armored or wheeled vehicles simultaneously
- ▶ Designed to operate nonstop day & night in all conditions
- ▶ Designed to easily convert into a chemical decontamination system



ALL WEATHER OPERATION TO -41F

INDEPENDENT POWER SOURCE // 100% WATER REUSE // MINIMAL SITE SETUP



“Enables military agricultural washing that conforms with and is in compliance with DoD, other US and other international environmental laws, guidelines and regulations.”

3 WASH POSITIONS

Underneath, Side level with vehicle, and Upper platform 4 feet above side level with integrated handrails

4 WATER CANNONS

Primary wash capability with high volume primary wash (up to 40 gpm @100 psi per nozzle) with four simultaneous stations as standard. (x2 water cannons per each side)

4 STEAM CANNONS

Secondary wash with four independent hot water/steam units allows every inch to be washed with up to 320F steam. (x2 steam cannons per each side)



x4 RAMP MODULES



x2 COLLECTION MODULES



TREATMENT MODULE



DEPLOYABILITY

PURPOSE-DESIGNED DEPLOYABILITY IN ISO 20FT SHIPPING CONTAINER FOOTPRINT

RAMP MODULE

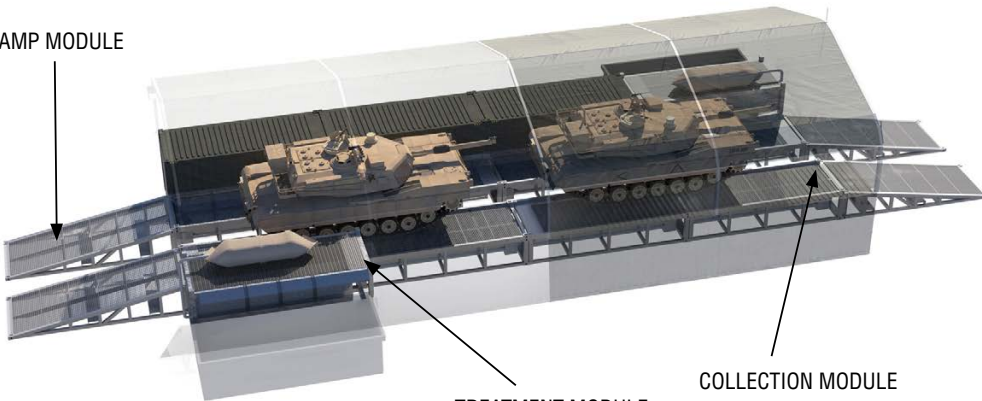

TREATMENT MODULE

COLLECTION MODULE

COLLECTION MODULE

- Raised platforms for access to underside of vehicles with 80 ton vehicle support capability
- Heavy duty SS Welded bar grate
- Primary screen for rocks and trash
- Walkway for wash operators
- Support for vehicle treads or tires
- Walkway for clarifier maintenance

- Integral V Bottom mud collection hopper
- Mud/Water capacity of 240 ft³/1,800 gallons with Mud capacity of 25,000lb
- Two Collection Modules mount on top of each other to form an approved ISO container for shipping
- Overflow on each unit directs water to next Collection Unit ensuring no spillage
- Dimensions 8ft wide x 20ft long x 8ft 3in high

- Integrated mud pump to transfer mud from collection hopper to clarifier or other tank or discharge
- Electric Diaphragm Pump 20 gpm flowrate with Premium Siemens SEW Eurodrive
- Heavy duty crank arm, rod design
- Pressure sensor assembly
- Run dry without damage and pump solids to 1.5 inches diameter or up to 50% by volume
- Pump weight under 80lbs , lightweight aluminum body
- Quick access internals and robust flapper check valve
- 8 per system

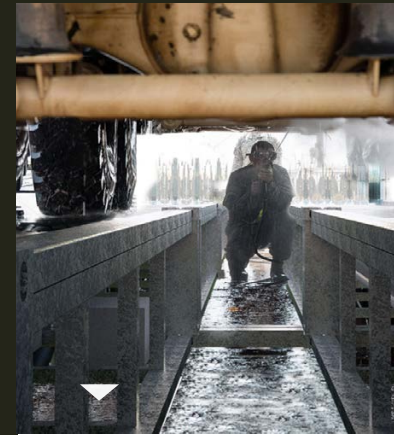

▲

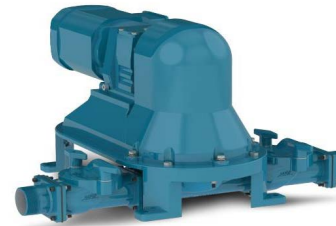

TREATMENT MODULE

- Longbox © Model MF
- V bottom retention tank
- Integral V Bottom mud collection shafted conveyor with heavy duty reduction drive
- 9" Dia x 3/8" thick Continuously welded both sides to 4" Sch 80 pipe
- Shaft supported by external bearings, no hanger bearings
- No internal wear surfaces

- Integral Mud Transfer pump to filter assembly
- Electric Diaphragm Pump 20 gpm flowrate with Premium Siemens SEW Eurodrive
- Heavy duty crank arm, rod design
- Pressure sensor assembly
- Run dry without damage and pump solids to 1.5 inches diameter or up to 50% by volume
- Pump weight under 80 lbs , lightweight aluminum body
- Quick access internals and robust flapper check valve

- Integrated upper deck Dewatered Mud Transfer Mechanism (DEMUT)
- Hydraulic Driven Dewatered Mud Transfer to dumpster

- Dewatering Filter Module with Mud Containment Disposable Bags
- Camlock fitting to dewatering filter for quick change
- Nominal 150 micron filter capacity
- One operator to dump mud and replace filter
- 10 minute bag dump/replace with no system stoppage
- No chemicals required



PROCESS

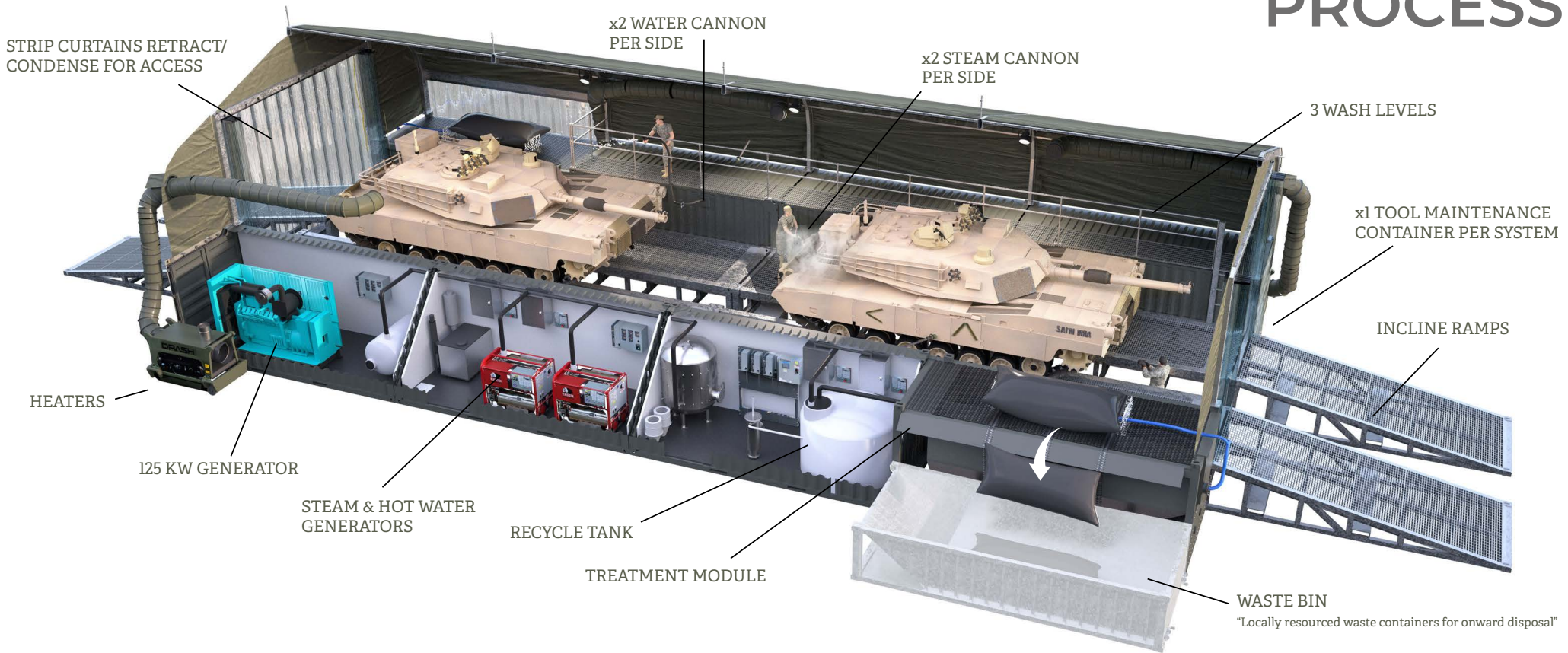

WATER CANNON STORAGE, FEED AND DELIVERY SYSTEM

1500 gallon recycle water tank fed by clarifier
Aeration system for water tank to keep water aerobic

High volume pumps feed two water cannons per side
Pumps maintain constant pressure in system
100 gpm of water at 100+ psi

Automatic Screen filter to protect water nozzles
316LSS Body
100 micron 316L SS weave wire screen
Bi-Directional patented drive
No motors, limit switches, gearboxes, pistons
Cleaning cycle does not interrupt filtration process,

Nozzles are designed for either 10-40 gpm at over 100 psi
Simple operation and rugged durability
Stainless steel ball shutoff
Lightweight aluminum construction with protective bumper
Hardcoat anodized aluminum
Quick change rear valve seat, positive shut off
1" rocker lug swivel

Hose reels are mounted inside the container
Operator access the hose from outside the container on the catwalk

STEAM CLEAN WASHER FEED (4 PER SYSTEM)

► Dual mode, oil Fired Hot Water/Steam generator
Hot/cold pressure mode for more powerful dirt and grime removal
Steam mode for cleaning grease and oil, sterilizing, disinfecting
320 def F pressurized temperature provides extreme cleaning impact
Ceramic, multiplunger water pump with forged bronze heads
Quick connects for hose, gun and wash tips
Approved for indoor or outdoor use. Low CO emissions
TEFC motor
Stainless Steel float tank
Heavy duty welded steel frame

► Shutoff guns standard on unit, stops hot water or steam discharge
when trigger released

► Desired temperature can be set on control panel display. Each operator
station can operate at a different temperature setting if desired (i.e. some
hot water, some steam)

► Water or Hot water mode: 8gpm at 3000 psi
Steam mode: 2.5gpm at 500 psi

x1 TOOL MAINTENANCE CONTAINER PER SYSTEM

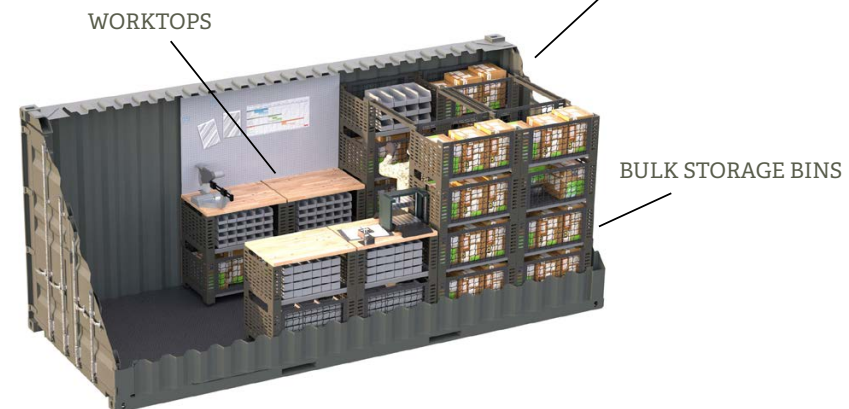

SPECIFICATION

PLAN VIEW

36.5m (120')

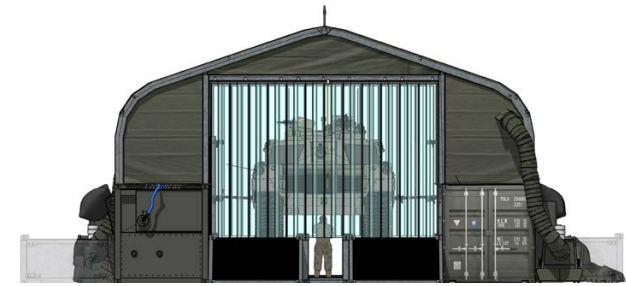
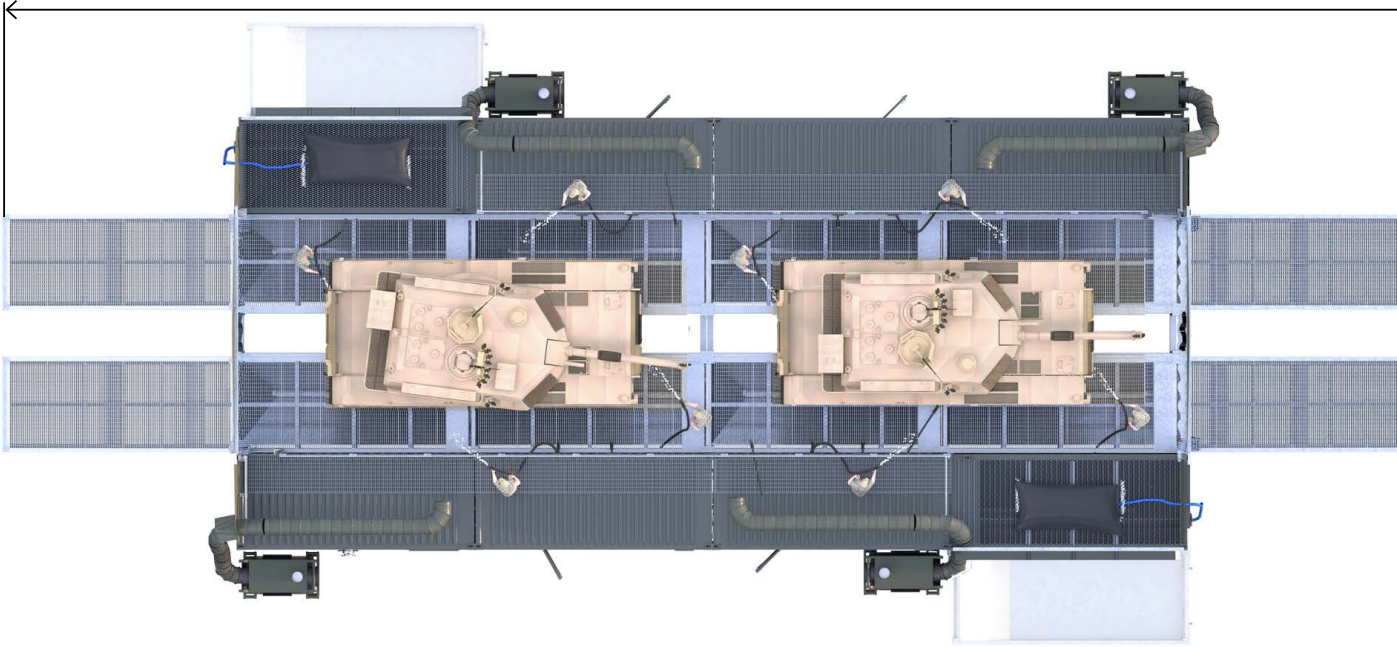

STRIP CURTAINS RETRACT AND CONDENSE FOR ACCESS

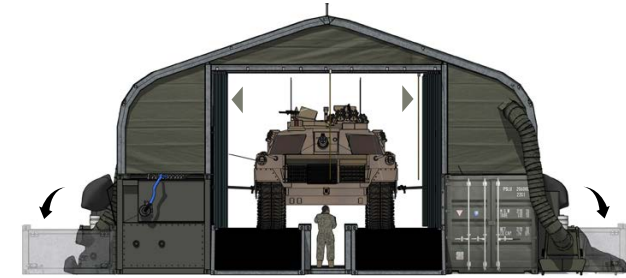

SECTION VIEW

STANDARD SYSTEM PROVIDES 2 WASH POSITIONS FOR ABRAMS TANK, 3/4 FOR OTHER VEHICLES

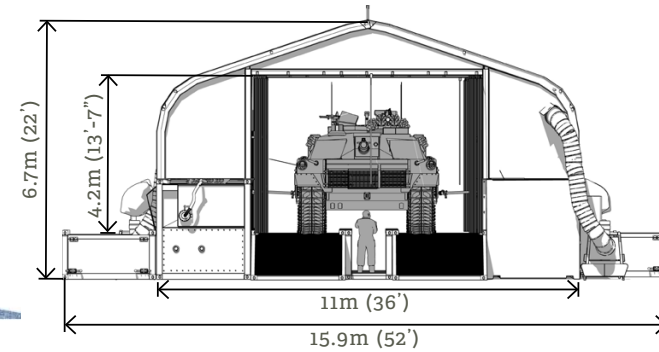
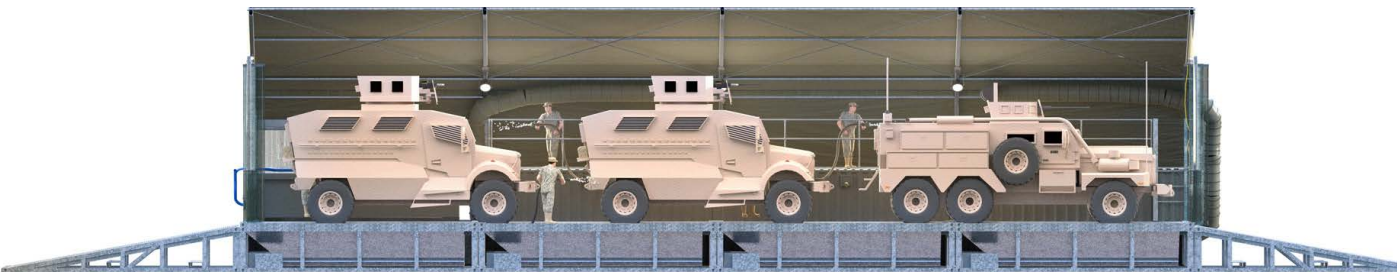

POWER MODULE (1 PER SYSTEM)

135kw (Prime) 150kw (Standby) Cummins Generator
 Diesel Powered
 480V, 60 hz, 3 phase
 Diesel tank 8-10 hrs at full rated output
 Housed in 20' container
 Exhaust into tent for heat recovery

HEATER MODULES (4 PER SYSTEM)

135kw (Prime) 150kw (Standby) Cummins Generator
 Diesel Powered
 480V, 60 hz, 3 phase
 Diesel tank 8-10 hrs at full rated output
 Housed in 20' container
 Exhaust into tent for heat recovery

ROOF ENCLOSURE

Heavy-duty aluminum frame roofing system with PVC fabric enclosure panels and translucent curtain track at either end for access.

MAINTENANCE CONTAINER

Everything organized for the system:
 Bulk storage bins / tools rack
 Work surfaces
 Peg Boards





WWW.BAN-AIR.COM
SALES@BAN-AIR.COM
919-753-8429